



IAdea + GoBright

Seriously Smart Solutions for Meeting Room and Visitor Management



Easy Room Booking

In advance or on the spot, hassle-free and easy room bookings



A Simply Better Meeting Experience

Less interruptions, more productive environments, and no double bookings

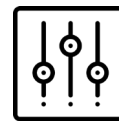

Total Room Control

All aspects of the meeting room controlled through a single pane of glass



Futuristic Reception Experience

A self-service reception gets guests registered and checked in without the wait



Visitor Monitoring and Management

Stay informed of who and where your guests are at all times for better security



Versatile Integration with Existing Systems

A real team player, these solutions integrate with existing business systems

Book Your Next Meeting Room in Seconds, Friction-Free!

Solution Highlights

- Enter your criteria, search for the perfect room and then book, easy!
- All but eliminate double bookings and unnecessary empty meeting rooms
- Better utilize fewer meeting rooms, saving property costs and reappropriating redundant space for more valuable functions
- Integrated NFC/HID card reader facilitates easy integrations with existing ID card systems and does away with the need for costly addons
- Happy to integrate with Exchange, Outlook, Office 365, Google Workspace, Active Directory and FMIS-systems



All Details Available at a Glance

Panels give a wealth of room information for viewers at a glance that is easily digestible, including current occupancy status, total capacity, and cleaning status as well as extra facilities that are on hand such as catering. The panel's ambient 360° halo light changes based on room status, so it is viewable, even from afar.

Search. Reserve. Meet.

Easily find an available room by reserving directly through the meeting room panel outside the room, or via the intuitive online portal, mobile app, or even directly through the Outlook integration. With just a few taps, book a room with the facilities and tools you need for a smooth, trouble-free meeting.

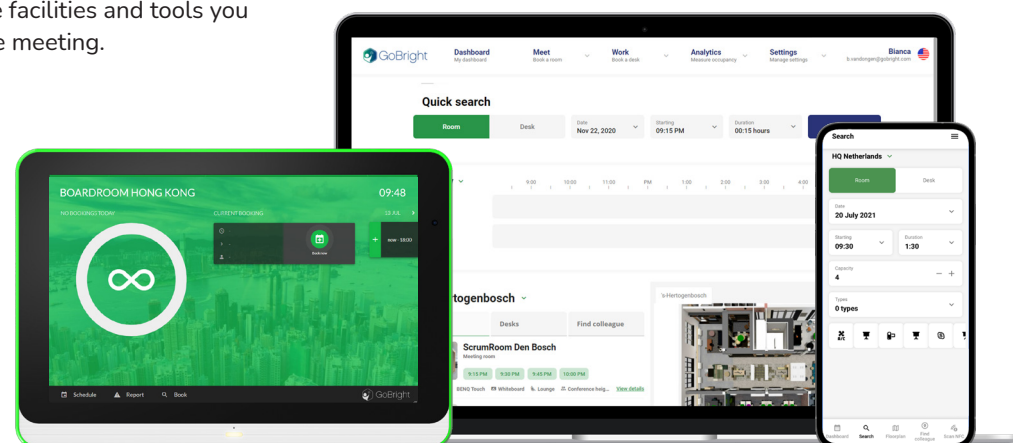

Easy ID Authentication for The Security Centric

The panel's superior hardware offers a smooth browsing experience that does not lag and is highly-responsive to touch. Fully-integrated HID and NFC readers make for seamless integration possible for security-conscious organizations with existing employee ID card systems. Employees need only tap their company-issued card to make, modify, or check in and out for their room booking.



Create an Impeccable Self-Service Experience for Visitors

Solution Highlights

- Create a technologically-driven reception experience that impresses visitors thanks to its simple and intuitive nature
- Accelerate the flow of guests and visitors, getting people where they need to be, quicker
- Keep visitors and guests happy by drastically cutting waiting times, especially in busy periods
- Reduced contact can potentially help lessen exposure of front desk staff
- Send automated notifications to meeting hosts once their guests are checked in at reception
- Real-time overview of current on-site guests enhances security and bolsters emergency preparedness
- Plug & play deployment means devices are ready to go in record time

Get Guests Registered Before They Even Arrive

Meeting hosts can easily register guests in advance and then issue a convenient QR code by email valid for the day and time of meeting. When guests arrive, they need only scan their code and they will be on their way to their meeting, entirely friction free. Furthermore, personal data is collected in a GDPR compliant manner, reducing organizational risk and for guests' peace of mind.

1. Preregister guests

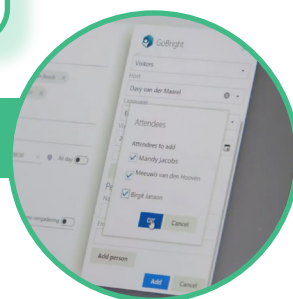

2. Send them their invite QR Code

3. Guests scan their QR code at front desk

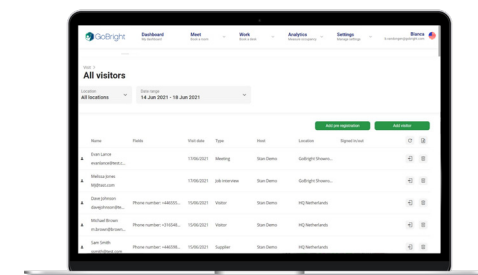
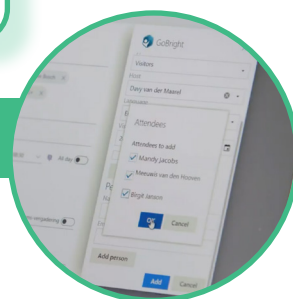

A Lasting First Impression

Blow away guests and visitors by leaving an unbeatable first impression with a futuristic self-service reception. Appealing panels and intuitive interfaces invite visitors to get registered, checked-in, and onto doing business. Paired with wayfinding capabilities, they can get clear directions to their meeting space with no worries about getting lost or being late.



4. ID badge is automatically printed

5. You're done!



A No-Wait Reception Experience

Being fully scalable, administrators can simply add more devices to match the expected quantity of guests and visitors to ensure there's absolutely no wait for everyone. They can also keep track of all visitor comings and goings throughout the day—knowing who was on site and when—for enhanced security, as well as vital guest location information in the event of emergencies.

Hitting the Ground Running

Devices can be preconfigured, facilitating simple plug & play deployment with a clean and tidy setup thanks to PoE support, saving valuable man hours. Lastly, extended functionalities such as integration with badge printing, guest pre-registration and a customizable software interface champion it as a total reception solution.

The Panel is Mightier Than the Sword

Solution Highlights

- Customize your meeting room—temperature, lighting, etc.—to just how you like it
- End or extend bookings with a simple tap to avoid interruptions
- Integrates with AV equipment for convenient control all through a single pane of glass
- Automate room features to boost your organization's sustainability and green credentials



One Screen, Complete Control

Panels go beyond just room booking; they can serve as a single point of control for all meeting room facilities. People can be very particular, it doesn't take much to be too hot, too cold or too bright. However, through the intuitive interface, adjust atmospheric factors such as heating and air conditioning, fans and airflow, or lighting and blinds to create the ideal personal environment for peak productivity

Keep Interruptions Outside the Meeting Room

When meetings overrun, there is no need to pick up the phone. Easily call in coffee or catering with a few taps and keep the meeting underway with minimal disruption. Or when equipment goes awry, report a malfunction with a tap so that tech support can be deployed to get things back in working order.

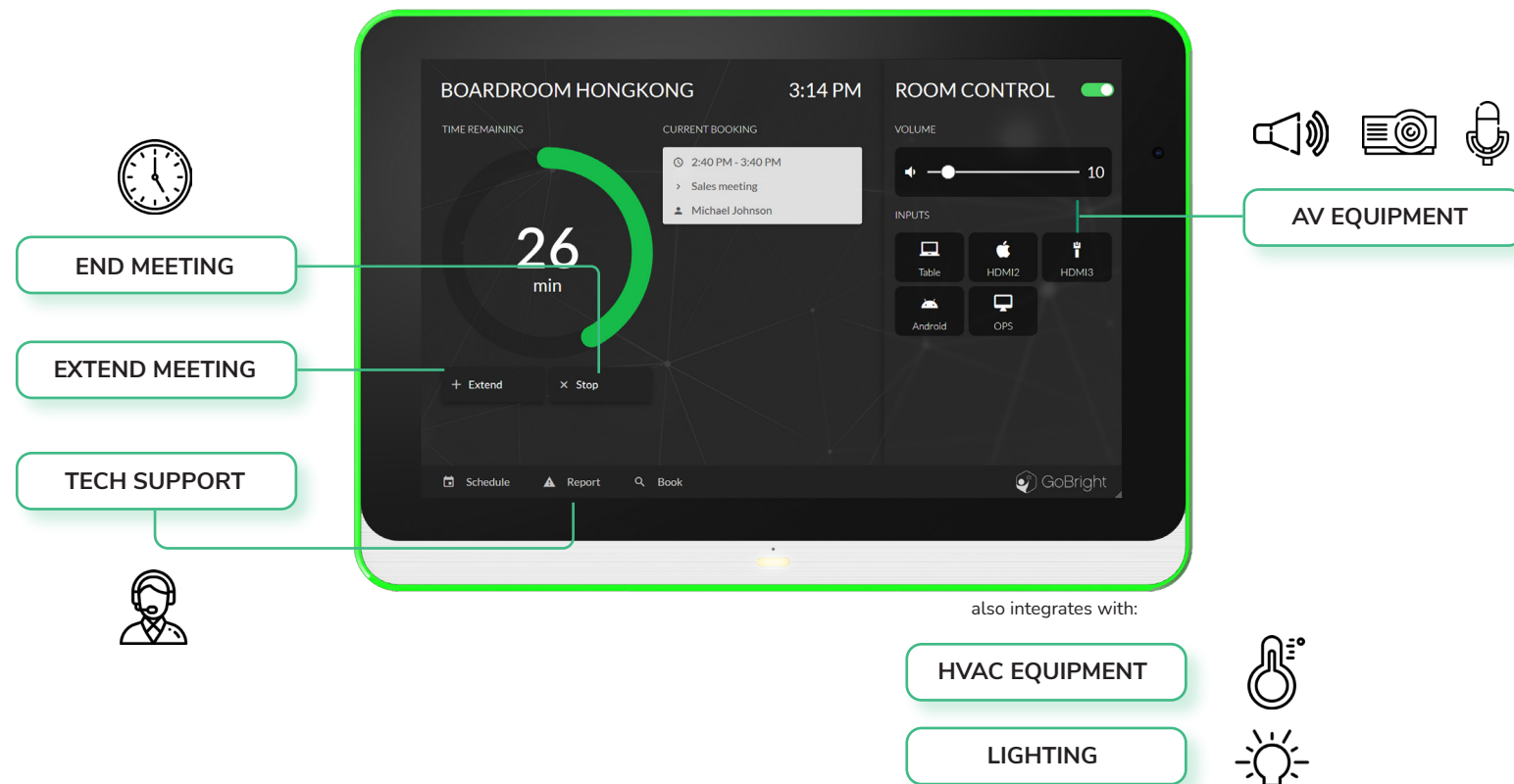

Better For Your Budget, Better for The Planet

For the increasingly environmentally-conscious organization, reducing energy waste is a priority. An occasionally forgotten about active air-con unit can sap resources and costs can quickly rack up, especially in large enterprises. Systems can be automated to switch everything off when no meeting is in progress, so even when room users forget to switch off, it's not a problem. Likewise, equipment can automatically enable before a meeting starts for greater user convenience.

Putting Your Workplace on The Map

Solution Highlights

- Make the most of the visually-friendly map view to find exactly the space you need: a quiet corner or right next to the coffee machine
- Browse immediate desk and meeting room availability and then reserve, right on the spot
- Easily locate where team mates are sat and book a desk right next to them
- Powerful hardware and high-sensitivity touch-screen make for a smooth and lag-free wayfinding experience
- Use 'Find my desk' to get situated and find the quickest route to your pre-booked desk
- Thanks to integration with other systems, space availability is always up to date
- Admins can access the portal to easily make changes to floor plans and provide a better experience

For Those Who Prefer a Visual-Based Approach

Sometimes an image just says it better. Map view gives a better understanding of floor layout, and helps people better choose the space that suits them. Busy morning printing? Book a desk next to the printer. Late night? Book a desk with the coffee machine directly in eyeshot. Likewise, quickly find where team members are sat and reserve a spot nearby for some unrestricted collaboration.

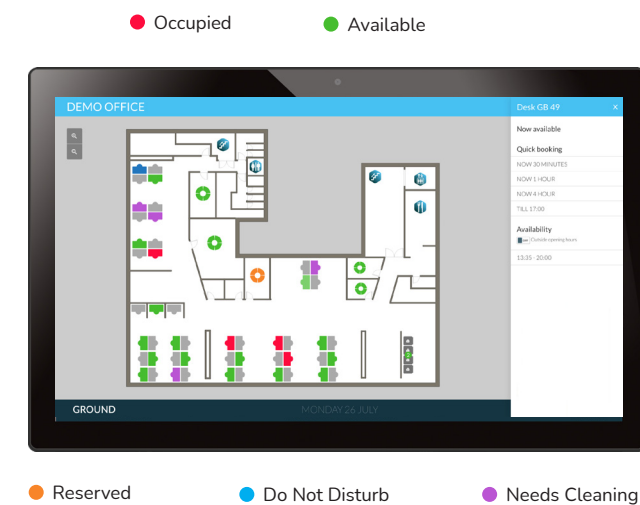
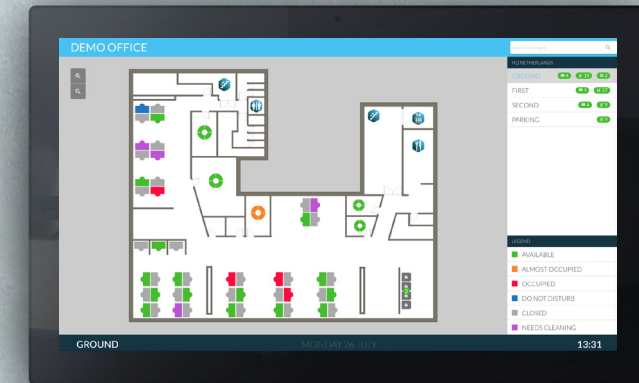
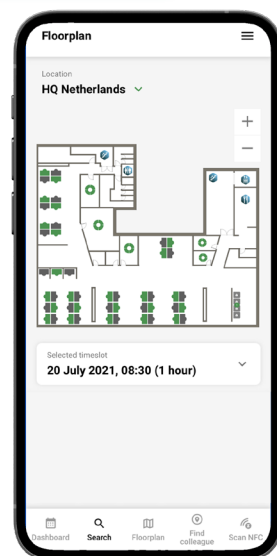

Never Out of The Loop

Thanks to integration with desk and room booking systems, maps are always up to date with the latest status information: which meeting rooms are in use, which desks are free for the rest of the afternoon and so on. Easily browse through floors to find the most suitable spot and then tap to book. Admins can also add points of interest, such as toilets and elevators, or mark spaces that are temporarily out of order with ease through the GoBright portal.

Flexible Deployment Options

Flexible mounting options allow easy deployment wherever a device is necessary, such as wall mounted directly outside of elevators so users can quickly get orientated or pole mount for a solution that is more mobile.



Keeping People on the Move

Solution Highlights

- Clearly display directions to meeting rooms, conference rooms, events or wherever necessary
- Locate in busy thoroughfares such as receptions, stair cases or next to lifts to get people moving in the right direction and reduce congestion
- Avoid information overload by easily defining only need-to-know information on screen such as upcoming events and bookings, or conference room capacity.
- Fully integrates with other systems, automatically updating screen contents with the latest information

High-Visibility Directions

Panel screens feature wide-viewing angle technology, making screen contents visible even when viewed from an angle. Likewise, high-visibility screens ensure viewers can read on-screen directions and text without trouble, even from afar.

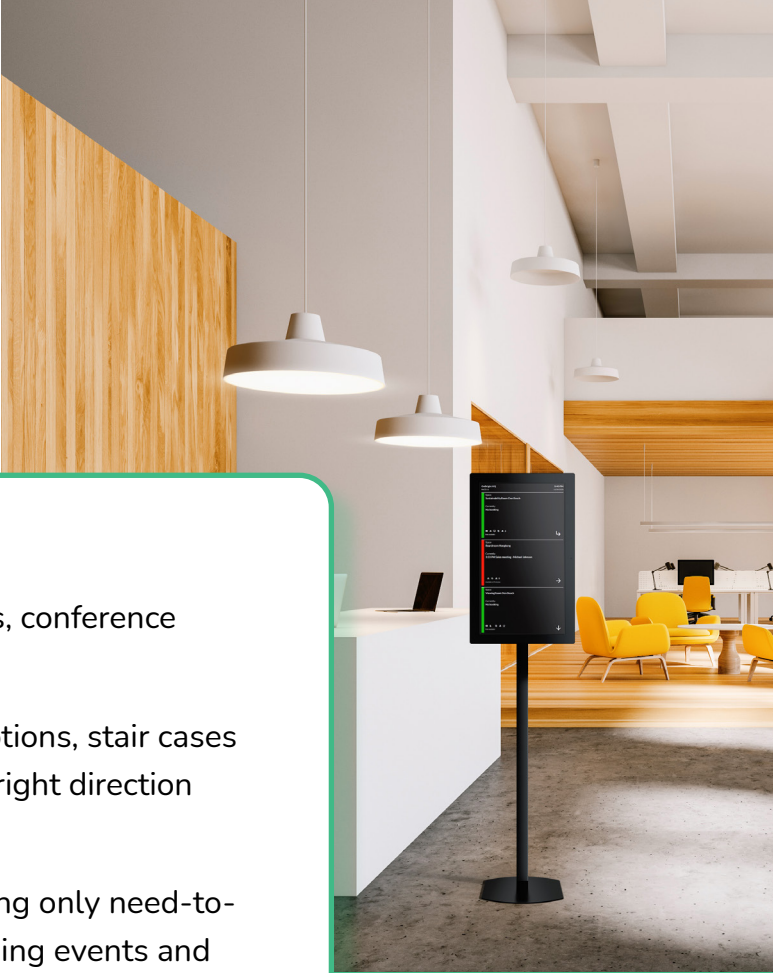
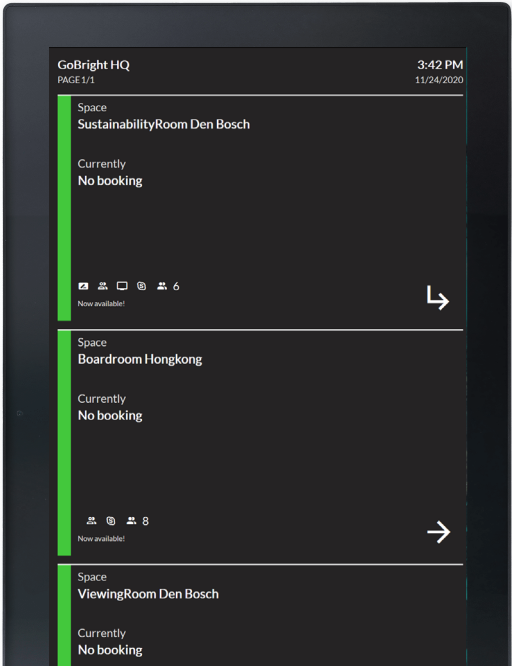

Get Traffic Flowing Again

Wayfinding information presented on a large well-lit screen is undeniably more professional than a quickly printed arrow on an A4 piece of paper or poor directions scribbled down and taped onto the wall. Place vibrant screens in key thoroughfares to get people going to where they need to be and improve the traffic flow throughout the area.

Technical Specifications

WRP-1000 Enterprise Room Booking Panel

| | | |
|--|--|--|
| Display | HTML5 Support | <ul style="list-style-type: none">• Glass mount sticker x 1• Glass mount cover sheet x 1• Mounting guide sheet |
| <ul style="list-style-type: none">• 10.1" LCD panel• 10 points capacitive multi-touch• 350 nits maximum brightness• 1280 x 800 panel resolution• Viewing angle (H / V): 80 / 80• Programmable surround with wall projection LED light• Front lens for identification | <ul style="list-style-type: none">• Widgets for calendar, clock, news, and web page integration• HTML5 technologies including CSS and Javascript• Chrome-based browser engine, same as Google Chrome™ | |
| Internal Player | Advanced Device Management Features | Optional Accessories |
| <ul style="list-style-type: none">• Processor: Cortex-A53 Octa-core• System memory: 2.0 GB• Flash memory: 16 GB eMMC built-in | <ul style="list-style-type: none">• Essential device administration controls• Full control over IAdeaCare deployment• Remote device diagnostic and forensics• Batch administration for device controls with filter functions• Device inventory and contract management• Device health analytics and troubleshooting• Central regulation of device access control• Create alert rules to monitor devices' online status | <ul style="list-style-type: none">• Power adapter• Power plug• GPIO connector• PTM-001 Tilt Wall Mount• PVK-102 Pivot Table Stand• PWM-011 & PWM-041 Premium Wall Mount |
| Video Format Supported | Connectivity | Power Requirement |
| <ul style="list-style-type: none">• H.264/AV up to 1080p (1920 x 1080)• H.265/HEVC up to 1080p (1920 x 1080)• MPEG-4 up to 1080p (1920 x 1080)• MPEG-2 up to 1080p (1920 x 1080)• MPEG-1 up to 1080p (1920 x 1080)• VC-1 up to 1080p (1920 x 1080) | <ul style="list-style-type: none">• Wi-Fi: 802.11 a/b/g/n/ac (supports 2.4 GHz and 5 GHz)• Micro USB for ADB• Ethernet RJ45: 1000BASE-T, 10/100/1000• Mbps LAN• Expansion port (supports physical access control pin / RS485 / GPIO)• Optical scanner (8 MP auto focus camera) x 1• Echo-cancellation microphone x 1• USB 2.0 x 2• Built-in 2 W stereo speaker x 1• 3.5 mm analog stereo audio out• Optional 3G / 4G mobile module via USB• Micro SD card slot, memory expandable to 16 GB / 32 GB / 64 GB (card replaces internal storage) | <ul style="list-style-type: none">• Input: 100 - 200 V, 50 – 60 Hz• Output: 12 V, 2 A• UL / CB certified power supplies• Interchangeable connector system includes US plug (optional for EU, UK, and AUS plugs)• IEEE 802.3 at Power-over-Ethernet (PoE+) |
| Image Format Supported | | Environmental |
| <ul style="list-style-type: none">• JPEG up to 1920 x 1080• PNG up to 1920 x 1080 | | <ul style="list-style-type: none">• Operating temperature: 0 °C – 40 °C / 32 °F – 104 °F• Humidity: 10 to 85 % @ 40 °C non-condensing |
| Audio Format Supported | | Dimensions for Product & Package |
| <ul style="list-style-type: none">• MP3 up to 320 kbps | | <ul style="list-style-type: none">• System Dimension: 261 mm x 181 mm x 29 mm (10.28" x 7.12" x 1.14")• System Weight: TBC• Individual package size: 320 mm x 90 mm x 255 mm (12.6" x 0.35" x 10.0")• Outer carton size: 480 mm x 280 mm x 350 mm (18.9" x 11.0" x 13.8")• Units per outer carton: 5 pcs |
| Room Management | | Certifications |
| <ul style="list-style-type: none">• 3rd party solution (optional license)• IAdea Solution Store | | <ul style="list-style-type: none">• CE / FCC / RoHS |
| Open Standards Supported | | Warranty |
| <ul style="list-style-type: none">• HTML5, Javascript, and CSS• Android 9.0 API• W3C SMIL or cross platform management• W3C HTML5 widgets• Support multimedia content playback such as video and image | NFC Spec <ul style="list-style-type: none">• WRP-1000-L / - A: 13.56 Mhz• WRP-1000-H: 13.56 Mhz & 125 Khz, HID Compliant | <ul style="list-style-type: none">• 1-year limited parts & labor* (varies based on region, contact sales for more details) |
| | Supplied Accessories | |
| | <ul style="list-style-type: none">• HW QSG• Built-in VESA compatible 75 mm x 75 mm posts• Back cover screws x 5 (M3*13 x 3, M3*6 x 2)• Flush mount back cover | |

Technical Specifications

XDS-2285 22” Non-Touch All-In-One Display

| Display | HTML5 Support |
|---|--|
| <ul style="list-style-type: none">21.5” IPS LCD panel250 nits maximum brightness1920 x 1080 (Full HD) panel resolutionViewing angle (H/V): 178/178 | <ul style="list-style-type: none">Widgets for calendar, clock, news, and web page integrationHTML5 technologies including CSS and JavascriptChromium-based browser engine, same as Google Chrome™ |
| Internal Player | Advanced Signage Features |
| <ul style="list-style-type: none">Processor: Cortex-A17 1.8 GHz Quad-CoreSystem memory: 2.0 GBFlash memory: 8 GB eMMC built-in | <ul style="list-style-type: none">Remote commissioningAlwaysOn, AppLock to prevent unauthorized accessStrongCache for continuous playback even when network is not availableMulti-zone screen layout, transparent PNG overlay, and graphical scrolling tickerAuto-play starts playing scheduled contents automatically when power is re-establishedAutomatic error recovery with built-in WDTReal-time clock with backup clock battery |
| Video Format Supported | Connectivity |
| <ul style="list-style-type: none">H.264/AVC up to 1080p (1920 x 1080)H.265/AVC up to 1080p (1920 x 1080)MPEG-4 up to 1080p (1920 x 1080)MPEG-2 up to 1080p (1920 x 1080)MPEG-1 up to 1080p (1920 x 1080)VC-1 up to 1080p (1920 x 1080) | <ul style="list-style-type: none">Front camera: 2MPWi-Fi: 802.11 b/g/nMini USB for ADB (Android Debug Bridge)Ethernet RJ45USB 2.0 x 3Built-in stereo speakers 2 W x 23.5 mm analog stereo audio outSD card slot, memory expendable to 16 GB / 32 GB / 64 GB (card replaces internal storage) |
| Image Format Supported | Mounting Options |
| <ul style="list-style-type: none">JPEG up to 1920 x 1080PNG up to 1920 x 1080 | <ul style="list-style-type: none">Built-in VESA MIS-D 100 mm x 100 mm mounting points |
| Audio Format Supported | |
| <ul style="list-style-type: none">MP3 up to 320 Kbps | |
| Content Management | |
| <ul style="list-style-type: none">SignApps Express utility3rd party solution (optional license) | |
| Open Standards Supported | |
| <ul style="list-style-type: none">HTML5, JavaScript, and CSSW3C SMIL for cross-platform managementW3C widgets for HTML deliveryAndroid 7.1 API | |

XDS-2288 22" Interactive Smart Kiosk

| Display | HTML5 Support | Supplied Accessories |
|---|---|--|
| <ul style="list-style-type: none">21.5” IPS LCD panel10 points capacitive multi-touch250 nits maximum brightness1920 x 1080 (Full HD) panel resolutionViewing angle (H/V): 178/178 | <ul style="list-style-type: none">Widgets for calendar, clock, news, and web page integrationHTML5 technologies including CSS and JavascriptChromium-based browser engine, same as Google Chrome™ | <ul style="list-style-type: none">Power adapterPower cordI/O bracketQuick guide |
| Internal Player | Optional Accessories | |
| <ul style="list-style-type: none">Processor: Cortex-A17 1.8 GHz Quad-CoreSystem memory: 2.0 GBFlash memory: 8 GB eMMC built-in | <ul style="list-style-type: none">Adjustable table stand (PVK-302) | |
| Video Format Supported | Power Requirement | Power Requirement |
| <ul style="list-style-type: none">H.264/AVC up to 1080p (1920 x 1080)H.265/AVC up to 1080p (1920 x 1080)MPEG-4 up to 1080p (1920 x 1080)MPEG-2 up to 1080p (1920 x 1080)MPEG-1 up to 1080p (1920 x 1080)VC-1 up to 1080p (1920 x 1080) | <ul style="list-style-type: none">Input: AC 100 ~ 240 V, 50 ~ 60 Hz, 1.5 A maxOutput: 12 V / 3 AUL/CB certified power supplies | <ul style="list-style-type: none">Input: AC 100 ~ 240 V, 50 ~ 60 Hz, 1.5 A maxOutput: 12 V / 3 AUL/CB certified power supplies |
| Image Format Supported | Environmental | Environmental |
| <ul style="list-style-type: none">JPEG up to 1920 x 1080PNG up to 1920 x 1080 | <ul style="list-style-type: none">Operating temperature: 0 to 40 °CHumidity: 10 to 85 % @ 45 °C, non-condensing | <ul style="list-style-type: none">Operating temperature: 0 to 40 °CHumidity: 10 to 85 % @ 45 °C, non-condensing |
| Audio Format Supported | Dimensions for Product & Package | Dimensions for Product & Package |
| <ul style="list-style-type: none">MP3 up to 320 Kbps | <ul style="list-style-type: none">System dimension: 538 mm x 331 mm x 37 mm (21.18" x 13.03" x 1.46")System weight: 3.83 kg (8.44 lbs)Package weight: 5.8 kg (12.78 lbs) | <ul style="list-style-type: none">System dimension: 538 mm x 331 mm x 37 mm (21.18" x 13.03" x 1.46")System weight: 3.83 kg (8.44 lbs)Package weight: 5.8 kg (12.78 lbs) |
| Content Management | Certifications | Certifications |
| <ul style="list-style-type: none">SignApps Express utility3rd party solution (optional license) | <ul style="list-style-type: none">CE / FCC / RoHS | <ul style="list-style-type: none">CE / FCC / RoHS |
| Open Standards Supported | Warranty | Warranty |
| <ul style="list-style-type: none">HTML5, JavaScript, and CSSW3C SMIL for cross-platform managementW3C widgets for HTML deliveryAndroid 7.1 API | <ul style="list-style-type: none">1-year limited parts & labor* (varies based on region, contact sales for more details) | <ul style="list-style-type: none">1-year limited parts & labor* (varies based on region, contact sales for more details) |



The Netherlands

Van Hennaertweg 6
2952 CA Alblasterdam
The Netherlands

Tel: +31 88 26 26 126
info@gobright.com



www.gobright.com



America

20 Fairbanks Str.
170 Irvine
CA 92618
USA

Tel: +1 949 305 6489
us-sales@iadea.com

Taiwan

3F, No. 21, Lane 168,
Xingshan Rd., Neihu Dist.
Taipei City 114
Taiwan (R.O.C)

Tel: +886 2 2791 1110
Fax: +886 2 2791 1170
sales@iadea.com



www.iadea.com